

# Castle Builder

**Situation:** Castles played a huge role in medieval society. They served as the primary means of defense and a sign of power and wealth. Each castle was uniquely designed with its own looks and defenses.

**Your Task:** Design a castle with the best defenses possible. You need to design it so that the people inside could survive a long siege. You will turn in two pictures of your castle. One will be an overhead view like a blueprint and the second will be a drawing of the castle if you were looking at the front of it.

## Instructions:

1. Overhead picture (not colored)
  - a. Sketch your castle as if you were looking down on it from above.
  - b. Label all the rooms and key parts.  
If you don't label it - it isn't there!  
Think about what you'd need in it to survive.
  - c. Include the area around your castle.  
Moat?  
Trees?  
Rocks?  
Walls?

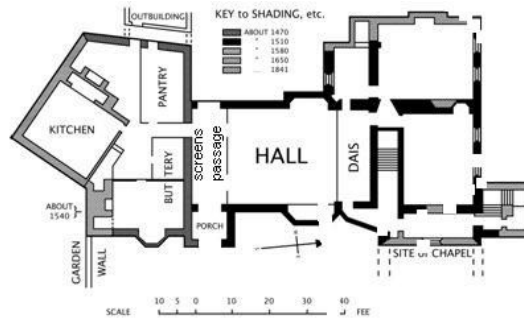

2. Front-view Picture (Colored)
  - a. Must show the castle entrance.
3. Write a 1 paragraph (5-7 sentence) description of your castle's defenses.
  - a. Include where it is located.
  - b. Explain any unique defenses or traps.
  - c. Explain anything that isn't shown clearly in your pictures.



4. Write a 1 paragraph (5-7 sentence) explanation of how an attack by an army of 1000 knights and 100 archers would be stopped by your defenses.